

Soji™ Solar Lantern with Bright LED

Congratulations on the purchase of your Soji™ Solar Lantern!
Setting up your Soji™ lantern is simple, follow the steps below:

Parts Included in Package:

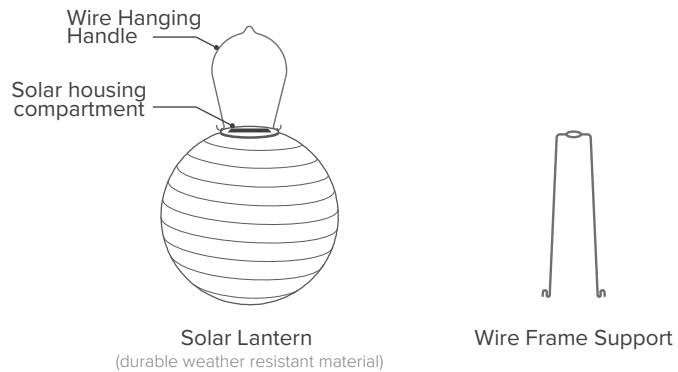

Instructions:

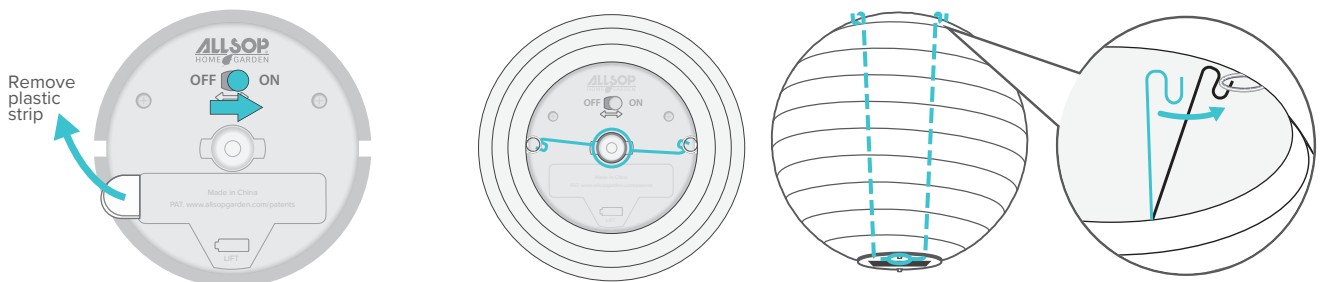

1. Slide Power Switch On

On the bottom side of the solar housing compartment, remove the plastic battery protector strip and discard it. Slide the power switch from the "Off" position over to the "On" position.

2. Attach Wire Frame Support

While the lantern is still in the flat collapsed position, snap the circular end of the metal wire frame support down around the LED. Pull the lantern up to form the shape. Then attach the notched ends of the wire frame support into the wire rings located on the bottom of the lantern.

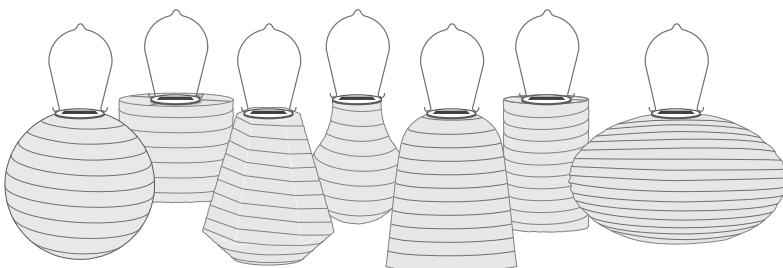

3. Enjoy!

Hang outside with the solar panel up to catch direct sunlight. The LED will illuminate automatically when it becomes dark.

THANK YOU FOR YOUR PURCHASE!

We want you to be completely satisfied. If you have any questions please contact our customer service department.

SUPPORT@ALLSOPGARDEN.COM
800-426-4303

Love your product? Please leave us a review!

